

Solar Crimp Kit for MC3 & MC4 - VISUAL AID

THE SOLAR CRIMP KIT IS DESIGNED FOR CRIMPING MC3/MC4 SOLAR MALE AND FEMALE TERMINALS TO (2.5 / 4 / 6mm²) 14 / 12 / 10 GAUGE SOLAR WIRES

- R624 105-02:**
- FOR MC3 MALE & FEMALE 14 / 12 / 10 GAUGE
 - FOR MC4 MALE & FEMALE 14 / 12 / 10 GAUGE

CAUTION!

This tool may be used only for the intended application and in strict compliance with all applicable safety rules, regulations and practices. It must be properly maintained, undamaged and in good working order. Unauthorized modification is prohibited and voids the manufacturer's warranty.

TERMINALS MAY HAVE SHARP EDGES. USE FINGER PROTECTION TO AVOID CUTS. DO NOT PLACE FINGERS IN TOOL AREAS, WHICH MAY PINCH DURING CRIMP CYCLE. USE SAFETY GLASSES TO AVOID EYE INJURY.



Solar Crimp Kit with Die Sets and locator for MC3 & MC4, Insulation Stripper, Cable Cutter RG



Die Sets and Locators for MC3 & MC4

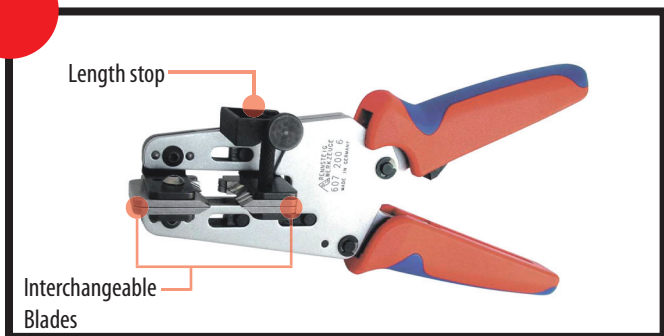

Insulation Stripper

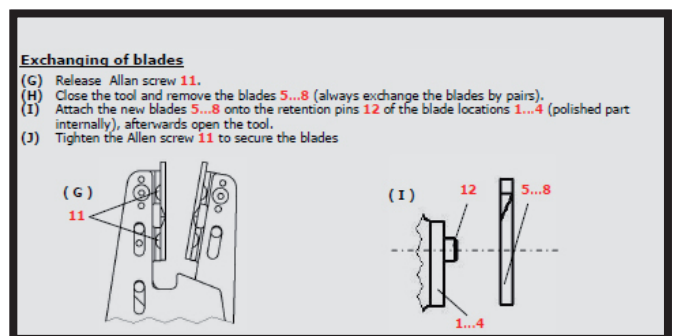

Change Blades



Cable Cutter RG (Cutter with reinforced grips)

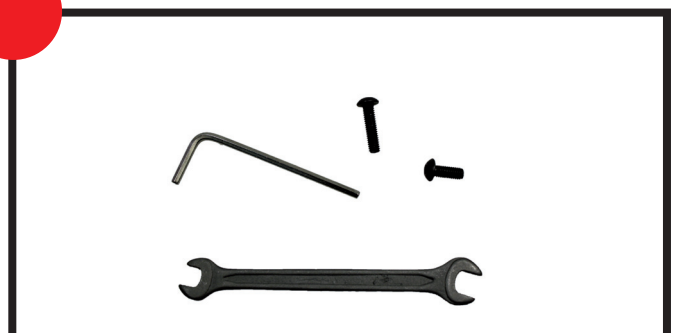

Alan Key, Screws, Open end wrench

Solar System Tool for MC3 - VISUAL AID

THE SOLAR SYSTEM TOOL IS DESIGNED FOR CRIMPING MC3 SOLAR MALE AND FEMALE TERMINALS TO (2.5 / 4 / 6mm²) 14 / 12 / 10 GAUGE SOLAR WIRES

624 194 3 1: FOR MC3 MALE & FEMALE 14 / 12 / 10 GAUGE

CAUTION!

This tool may be used only for the intended application and in strict compliance with all applicable safety rules, regulations and practices. It must be properly maintained, undamaged and in good working order. Unauthorized modification is prohibited and voids the manufacturer's warranty.

TERMINALS MAY HAVE SHARP EDGES. USE FINGER PROTECTION TO AVOID CUTS. DO NOT PLACE FINGERS IN TOOL AREAS, WHICH MAY PINCH DURING CRIMP CYCLE. USE SAFETY GLASSES TO AVOID EYE INJURY.

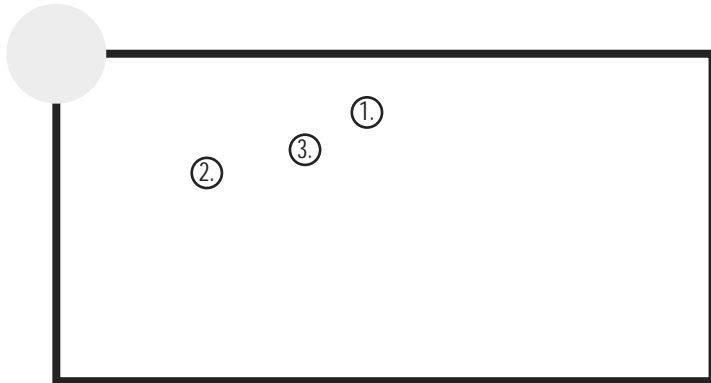

1. Tool 2. Locator 3. Die



Compress handles until dies open. Select cable size as shown on top of crimp plate.



Hold tool so that the terminal can drop into the locator round hole. Make sure terminal is fully seated in the locator.



Press handles together until terminal is properly positioned.

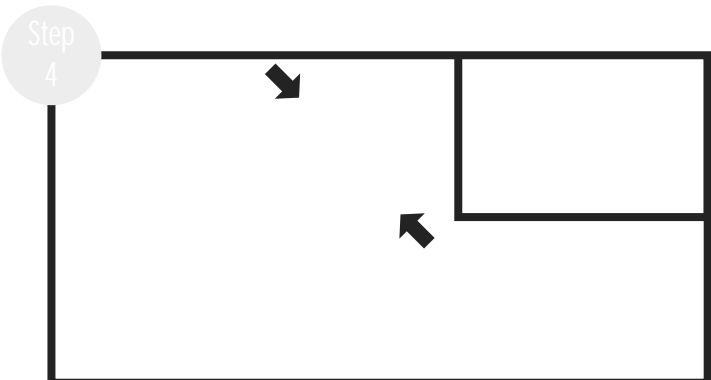

Position stripped end in the terminal, COMPRESS THE HANDLES UNTIL THE RATCHET AUTOMATICALLY RELEASES. CRIMPING PROCESS IS COMPLETED.



If jam occurs slightly compress handle while using fingers to rotate release clockwise.

Step
6



Loosen the locking screw to change crimping dies, using Allen key (2.5 mm).

Step
7



Loosen the locking screw for changing the locator, using Allen key (2.5 mm).

Also available interchangeable crimp dies and locators for your Solar System Tool

MC 4 Die Set

MC 4 Locator

R624 570 3 0

R624 570 0 01

Tyco Die Set

Tyco Locator

R624 817 3 0

R624 817 0 01

Solar Crimp Set

(in plastic case)

Content:

- MC3 Die Set and Locator
- MC4 Die Set and Locator
- Tyco Die Set and Locator

R624 105-01

LIMITATION OF LIABILITY

RENNSTEIG WERKZEUGE GMBH IS NOT LIABLE FOR CONSEQUENTIAL OR SPECIAL DAMAGES OF ANY NATURE OR KIND RESULTING FROM USE, OR MISUSE, OF ANY OF ITS PRODUCTS. OWNERS AND USERS OF RENNSTEIG WERKZEUGE GMBH PRODUCTS ASSUME FULL RESPONSIBILITY FOR INSTRUCTING THEIR EMPLOYEES IN THE PROPER AND SAFE USE OF SUCH PRODUCTS.

PERIODIC INSPECTION PROCEDURE

VISUAL INSPECTIONS SHOULD BE PERFORMED ON THE TOOL BASED ON THE AMOUNT OF USE, WORKING CONDITIONS AND OPERATOR SKILL AND CARE.

- A. CLEAN TOOL DIE AREA WITH SOLVENT OR BRUSH.
- B. CHECK CRIMP AREA OF DIES OF DAMAGE.
- C. IF TOOL JAMS OR LOCKS, CHECK RATCHET FOR DIRT AND LUBRICATION.

CARE OF TOOL

WE STRONGLY RECOMMEND THAT YOU:

1. **DO NOT** IMMERSE TOOLS IN CLEANING SOLUTION.
2. **DO NOT** SPRAY OIL INTO TOOL TO LUBRICATE.
3. **DO NOT** ATTEMPT TO DISASSEMBLE TOOL OR MAKE REPAIRS.

THIS IS A PRECISION HAND CRIMPING TOOL AND SHOULD BE HANDLED AS SUCH.

Solar System Tool for MC4 - VISUAL AID

THE SOLAR SYSTEM TOOL IS DESIGNED FOR CRIMPING MC4 SOLAR MALE AND FEMALE TERMINALS TO (2.5 / 4 / 6mm²) 14 / 12 / 10 GAUGE SOLAR WIRES

624 570 3 1: FOR MC4 MALE & FEMALE 14 / 12 / 10 GAUGE

CAUTION!

This tool may be used only for the intended application and in strict compliance with all applicable safety rules, regulations and practices. It must be properly maintained, undamaged and in good working order. Unauthorized modification is prohibited and voids the manufacturer's warranty. TERMINALS MAY HAVE SHARP EDGES. USE FINGER PROTECTION TO AVOID CUTS. DO NOT PLACE FINGERS IN TOOL AREAS, WHICH MAY PINCH DURING CRIMP CYCLE. USE SAFETY GLASSES TO AVOID EYE INJURY.

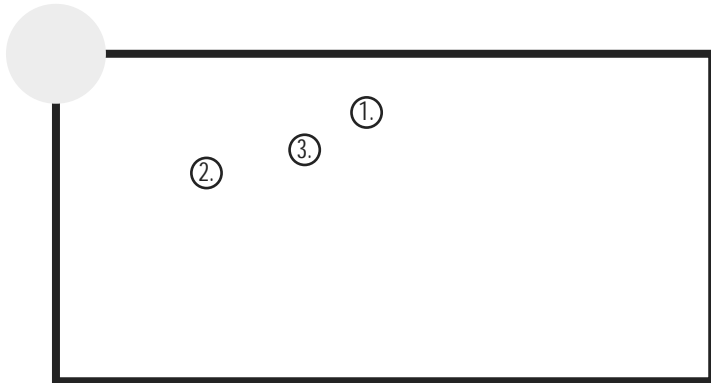

1. Tool 2. Locator 3. Die



Compress handles until dies open. Select cable size as shown on top of crimp plate.

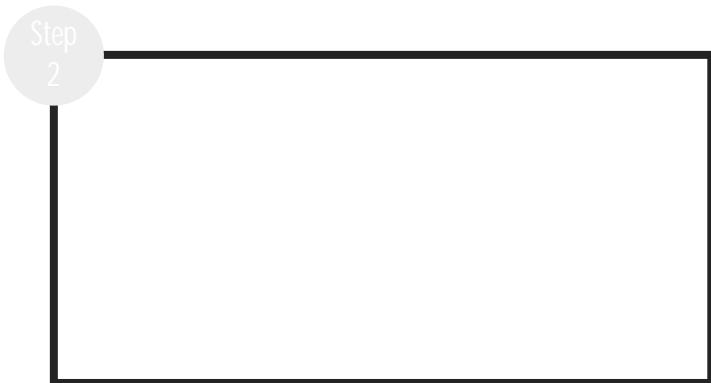

Hold tool so that the terminal can drop into the locator round hole. Make sure terminal is fully seated in the locator.



If necessary use your fingers for assistance to prevent the terminal from twisting.

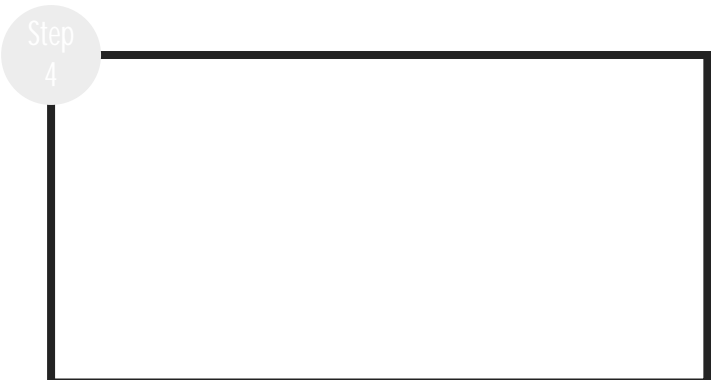

Press handles together until terminal is properly positioned.

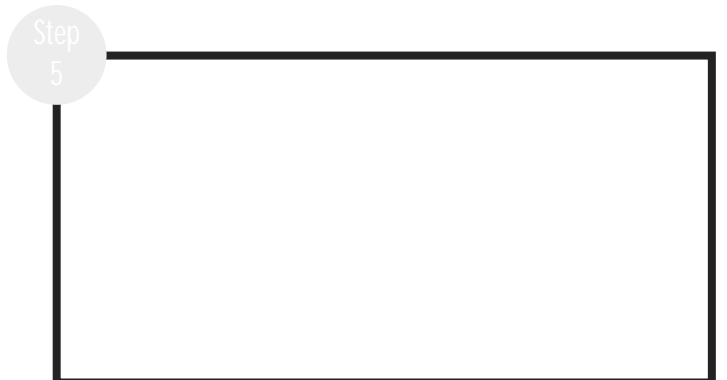

Position stripped end in the terminal and compress handles observing that terminal wings do not twist.

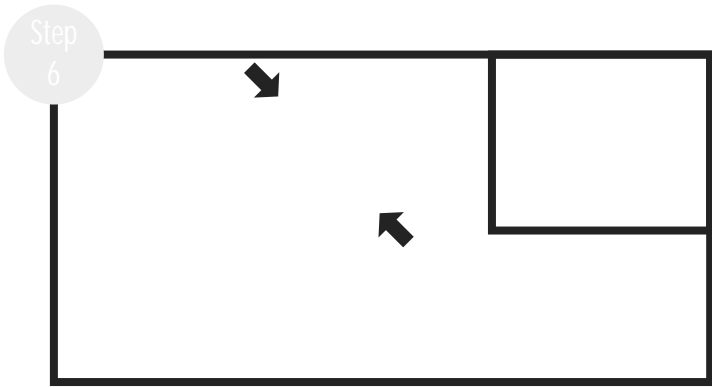

COMPRESS THE HANDLES UNTIL THE RATCHET AUTOMATICALLY RELEASES. CRIMPING PROCESS IS COMPLETED.



If jam occurs slightly compress handle while using fingers to rotate release clock wise.

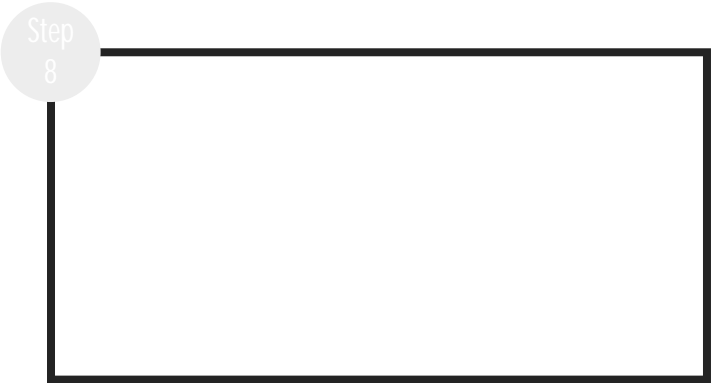

Loosen the locking screw to change crimping dies, using Allen key provided.



Loosen the locking screw for changing the locator, using Allen key provided.

Also available interchangeable crimp dies and locators for your Solar System Tool

MC 3 Die Set	MC3 Locator
R624 194 3 0	R624 194 0 01

Tyco Die Set	Tyco Locator
R624 817 3 0	R624 817 0 01

Solar Crimp Set (in plastic case) Content: - MC3 Die Set and Locator - MC4 Die Set and Locator - Tyco Die Set and Locator R624 105-01
--

LIMITATION OF LIABILITY

RENNSTEIG WERKZEUGE GMBH IS NOT LIABLE FOR CONSEQUENTIAL OR SPECIAL DAMAGES OF ANY NATURE OR KIND RESULTING FROM USE, OR MISUSE, OF ANY OF ITS PRODUCTS. OWNERS AND USERS OF RENNSTEIG WERKZEUGE GMBH PRODUCTS ASSUME FULL RESPONSIBILITY FOR INSTRUCTING THEIR EMPLOYEES IN THE PROPER AND SAFE USE OF SUCH PRODUCTS.

PERIODIC INSPECTION PROCEDURE

VISUAL INSPECTIONS SHOULD BE PERFORMED ON THE TOOL BASED ON THE AMOUNT OF USE, WORKING CONDITIONS AND OPERATOR SKILL AND CARE.
 A. CLEAN TOOL DIE AREA WITH SOLVENT OR BRUSH.
 B. CHECK CRIMP AREA OF DIES OF DAMAGE.
 C. IF TOOL JAMS OR LOCKS, CHECK RATCHET FOR DIRT AND LUBRICATION.

CARE OF TOOL

WE STRONGLY RECOMMEND THAT YOU:
 1. **DO NOT** IMMERSE TOOLS IN CLEANING SOLUTION.
 2. **DO NOT** SPRAY OIL INTO TOOL TO LUBRICATE.
 3. **DO NOT** ATTEMPT TO DISASSEMBLE TOOL OR MAKE REPAIRS.
 THIS IS A PRECISION HAND CRIMPING TOOL AND SHOULD BE HANDLED AS SUCH.